



H7E - C / T / R

TOTAL COUNTER / TIME COUNTER
DIGITAL TACHOMETER
User's Manual

SAFETY PRECAUTION

This manual uses the following symbols to ensure safe operation of this timer.

- WARNING** Warnings are indicated when mishandling this controller might result in death or serious injury to user.
- CAUTION** Cautions are indicated when mishandling this controller might result in minor injury to the user, or only physical damage to the timer.

WARNING

- Note this incorrect wiring of this controller can damage it and lead to other hazards. Make sure the controller has been correctly wired before turning the power ON.
- Before wiring, or removing / mounting the controller, be sure to turn the power OFF. Failure to do so might cause electric shock.
- Do not touch electrically charged parts such as the power terminals. Doing so might cause electric shock.
- Do not disassemble the controller. Doing so might cause electric shock or faulty operation.

CAUTION

- Use the controller within the operating ranges recommended in the specification (temperature, humidity, voltage, shock, mounting direction, atmosphere and etc.). Failure to do so might cause fire or faulty operation.
- Firmly tighten the terminal screws. Insufficient tightening of terminal screws might cause electric shock or fire.

RESTRICTIONS ON USE

When using this product in applications that require particular safety or when using this product in important facilities, please pay attention to the safety of the overall system and equipment. Install fail-safe mechanisms, perform redundancy checks and periodic inspections and adopt other appropriate safety measures when it is necessary. This product is rated at Class II □.

SPECIFICATION		USAGE	
Battery Voltage	DC: 3V(Battery: CR123A)	H7E-C Max. counting speed	30Hz, 1KHz
Battery Life	H7E-C/R:7 years min. · H7E-T:10 years min. (at 25℃)	H7E-R Max. counting speed	RA=1KHz RB=10KHz
Supply Voltage	For backlight : AC/DC 24V	Max. revolutions => Applicable encoder resolution	
Allowable Supply Voltage Range	85 ~ 110% of rated operating voltage	RA: 1000 rps => 1 pulse/rev.	
Rated Frequency	50 / 60 Hz	RA: 1000 rpm => 60 pulse/rev.	
Power Consumption	Approx. 0.8W/2.4VA	RB: 1000.0 rps => 10 pulse/rev.	
Ambient Temperature	-10 ~ +50 ℃	RB: 10000 rpm => 60 pulse/rev.	
Ambient Humidity	MAX 85% RH	RB: 1000.0 rpm => 600 pulse/rev.	
Weight	Approx. 62g		

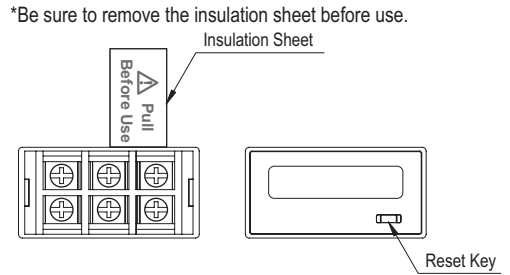

BATTERY REPLACEMENT

1. Use a flat head screwdriver to pry open the lift-tab on the both sides of the case.

2. Pull the body out of its outer case.

3. Remove the battery and insert the new one.

Ensure that the positive (+) and the negative (-) terminals are correctly aligned. Please complete this step within 30 second to preserve the existing value.

1.

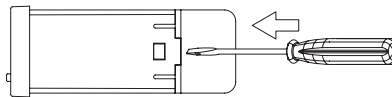

2.

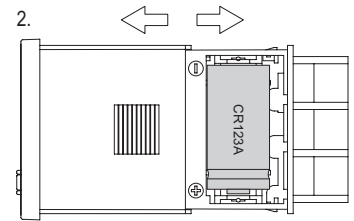

CONNECTION AND SWITCH

1.H7E-C, H7E-T:

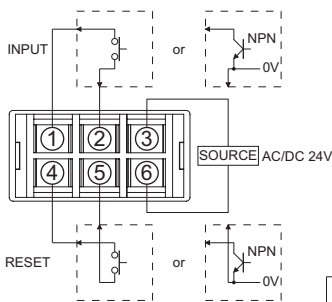

2.H7E-R:

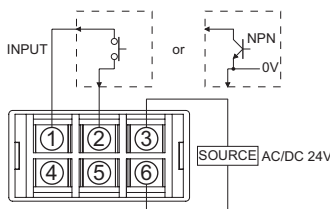

	a	b	c	d
H7E-C	Key-protect OFF	Key-protect	30Hz	1KHz
H7E-TA	Key-protect OFF	Key-protect	3999d23.9h	999999.9h
H7E-TB	Key-protect OFF	Key-protect	9999h59.9m	999h59m59s
H7E-RA	N/A	N/A	N/A	N/A
H7E-RB	N/A	N/A	10000rpm	1000.0rpm/rps

PANEL CUTOUT(mm)

1.Single Unit

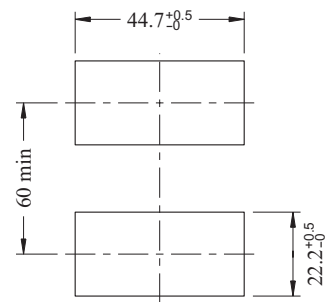

2.Multiple Units

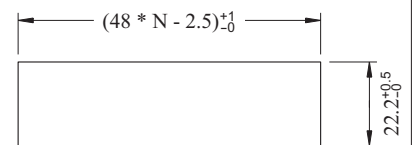

N=No. of units

DIMENSIONS(mm)

