



# ANLY CONTROLLER

## PU-N CONTROLLER UNIT



PU-NA  
PU-NB  
PU-NC

PU-NE

### CHARACTERISTIC :

- Proximity and photoelectric swithes power supply controller
- Stabilized power source, DC 24V for PU-NA, PU-NB and DC 12V for PU-NC, PU-NE
- 1C (SPDT) output contact with 5A capacity

### SPECIFICATION :

Operating voltage	AC(V) : 110, 220, 240 AC(V) : 110 / 220(PU-NE)
Allowable operating voltage range	85~110% of rated operating voltage
Rated frequency	50 / 60 Hz
Contact rating	250VAC 5A (resistive load)
Reset time	- - - -
Power consumption	Approx. 2VA
Life	Mechanical: 5,000,000 times Electrical: 100,000 times
Ambient temperature	-10 ~ +50°C
Ambient humidity	MAX 85%RH
Weight	PU-NA, -NB, -NC Approx. 150g PU-NE Approx. 210g

### TYPE SELECTION :

Type	PU-NA	PU-NB	PU-NC	PU-NE
Output voltage	DC 24V	DC 24V	DC 12V	DC 12V
Connet proximity	P type	N type	P-N type	P-N type
Active	Hi active	Low active	Hi or Low active	Hi or Low active

## CONNECTION :

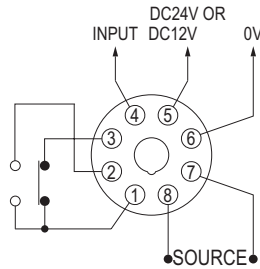

## TIMING CHART :

PU-NA,B,C

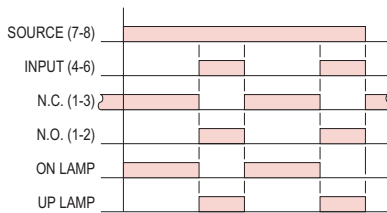

PU-NE

NORMAL MODE

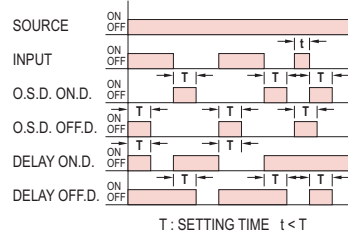

T : SETTING TIME  $t < T$

INVERSE MODE

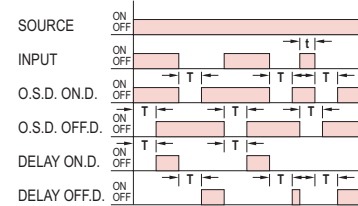

T : SETTING TIME  $t < T$

## DIMENSIONS : (mm)

N type(Surface Mounting): Using PF085A Socket & FH-3 (PU-NA, -NB, -NC )

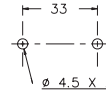
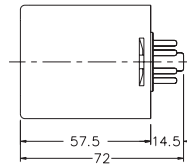
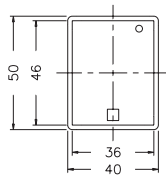

Y type(Flush Mounting): Using 8PFA Socket (PU-NE )

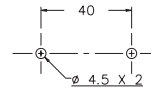
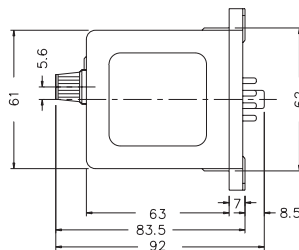
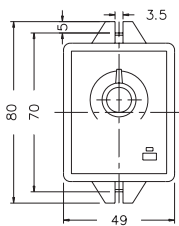

## ONLY ELECTRONICS CO., LTD.

<http://www.ONLY.com.tw>

### TAIWAN MAIN OFFICE : ONLY ELECTRONICS CO., LTD.

No.19, Lane 202, Fushou St., Shinjuang City, Taipei, Taiwan 242  
TEL: +886-2-2996-3202 FAX: +886-2-2996-2017

### MALAYSIA BRANCH : JUSTY ELECTRONICS (M) SDN, BHD.

No.1, Jalan 6/89B, Kawasan Perindustrian Trisegi, Batu 3 1/2 Off Jalan Sungei Besi, 57100 Kuala Lumpur, Malaysia  
TEL: +60-3-7983-5758 FAX: +60-3-7981-5052

### HONG KONG BRANCH : ONLY ELECTRONICS (HK) LTD.

Flat K, 13/F, Edward Mansion, 141 Prince Edward Road W., Kowloon, Hong Kong  
TEL: +852-2397-2505 FAX: +852-2397-6080

### SHANGHAI BRANCH : ONLY TECHNOLOGY (WUXI) CO., LTD.

Room 13G, No.831, Xinzha Rd., Jingan District, Shanghai, China 200041  
TEL: +86-21-6218-3300 FAX: +86-21-6217-5911